

\$1,171 - 11400 Domain Drive 5105, Austin

MLS® #4742937

\$1,171

1 Bedroom, 1.00 Bathroom, 580 sqft
Rental on 0.00 Acres

DOMAIN SOUTH END, Austin, TX

WORK, PLAY, AND LIVE IN STYLE | Enjoy immediate proximity to retail, restaurants, industry, and more at your apartment in Austin's "Second Downtown." A tranquil courtyard welcomes you into your new home, a sophisticated community featuring spacious apartments with floor-to-ceiling windows, private balconies and patios*, and gourmet kitchens. Residents are treated to a modern fitness center and a resort-style pool that is sure to impress. Just 11 miles from downtown Austin and minutes from Dell, IBM, and National Instruments, life here is the perfect blend of work and play. *Features vary by unit. THIS IS AN AFFORDABLE HOUSING UNIT
Income requirements between \$39,346 - \$50,200 annually

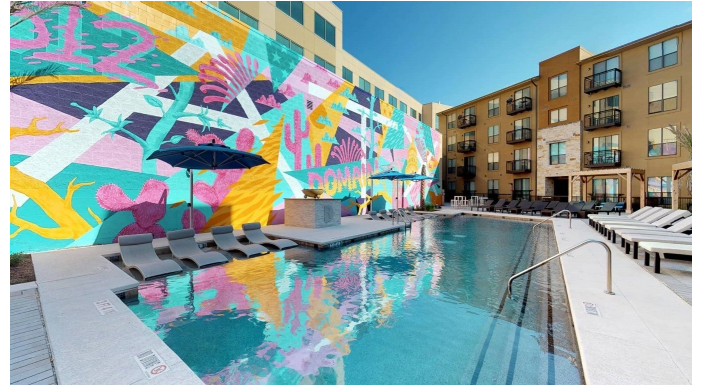

Built in 2007

Essential Information

ListingFeed	abor_vow
MLS® #	4742937
List Price	\$1,171
Sale Price	\$1,171
Sale Date	April 19th, 2023
Bedrooms	1
Bathrooms	1.00
Full Baths	1
Square Footage	580
Acres	0.00

Year Built	2007
Type	Rental
Sub-Type	Apartment
Status	Closed

Community Information

Address	11400 Domain Drive 5105
Subdivision	DOMAIN SOUTH END
City	Austin
County	Travis
State	TX
Zip Code	78758

Amenities

Utilities	None, Sewer Not Available, Water Not Available
Features	Business Center, Common Grounds/Area, Courtyard, Fitness Center, Gated, Internet Access, Maintenance On-Site, Property Manager On-Site, Rooftop Lounge, Shopping, Sidewalks
Parking	Enclosed, Covered, Guest
# of Garages	1
View	City
Waterfront	None
Has Pool	Yes

Interior

Interior	Carpet
Appliances	Cooktop, Dishwasher, Free-Standing Electric Range, Disposal, Refrigerator, Washer
Heating	Central
Cooling	Central Air
# of Stories	1
Stories	One

Exterior

Lot Description	None
Windows	Solar Screens
Roof	None
Foundation	None

School Information

District	Austin ISD
Elementary	Pillow
Middle	Burnet (Austin ISD)
High	Anderson