

\$2,500,000 - 13641 Rutledge Spur, Austin

MLS® #5554442

\$2,500,000

0 Bedroom, 0.00 Bathroom,
Commercial Sale on 2.51 Acres

Schirpik & Sane Tracts, Austin, TX

Prime location and surrounded high quality new developments.? Potential to be an apartment, condominium.?

Site plans and building plans for 19,000 sf office building plans have been approved recently.?

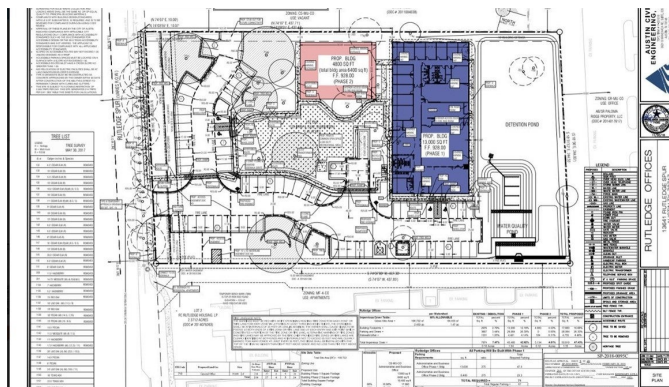

Built in 1980

Essential Information

ListingFeed	abor_vow
MLS® #	5554442
List Price	\$2,500,000
Sale Price	\$2,550,000
Sale Date	April 15th, 2022
Bathrooms	0.00
Acres	2.51
Year Built	1980
Type	Commercial Sale
Sub-Type	Office
Status	Closed

Community Information

Address	13641 Rutledge Spur
Subdivision	Schirpik & Sane Tracts
City	Austin
County	Williamson
State	TX
Zip Code	78717

Amenities

Utilities	Electricity Available, Phone Available
Parking	Asphalt, Gravel
View	None

Interior

Interior	See Remarks
Heating	None
Cooling	None

Exterior

Lot Description	Level
Foundation	Slab